

**CLEANING INSTRUCTIONS**  
MULTIFRUIT

**Caution!** For a correct cleaning process please follow the instructions below. Make sure machine is unplugged from electrical current.

Zumex recommends **cleaning the machine at least once or twice a day**, depending on how much it is used in order to maintain optimal food hygiene conditions.



1 Raise security handle.



2 Remove security handle by positioning horizontally and pulling handle in the opposite direction.

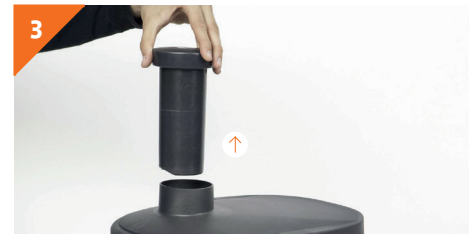

3 Remove food pusher.



4 Remove tap by pulling out.



5 Remove top Multifruit lid by lifting upwards.



6 Remove waste container by pulling up horizontally.



7 Disassemble grating filter and juice tank by pulling upwards.



8 Separate filter from filter cover.  
**ATTENTION!** Do not touch the sharp points of the grater as they could cut you.



9 Remove coaster from coaster tray by inserting your index finger and pulling out gently.



10 Pull out coaster tray.



11 Clean parts.

**! INFORMATION**

All pieces, **EXCEPT THE FRONT COVER**, can be cleaned in a dishwasher.

The juice extraction zone and the front cover should be cleaned using a moist cloth and dish washing liquid. Rinse with clean water to remove any washing liquid traces.

**To assemble the machine repeat the process in reverse and ready to work.**